

Specifications **38** SUPER SPORT ²⁰¹²



LOA with platform and gunnel molding	39' 11"	12,2 m
Beam with gunnel molding	36' 6"	11,1 m
Draft with IPS engines	31.5"	0,8 m
Weight with fuel, water & engine	25,000 lbs. (approx.)	11566 kg
Bridge Clearance with arch	14' 1"	4,3 m
Fuel System	334 U.S. gallons	1264 liters
Water System with inboard engine	75 U.S. gallons	284 liters
Holding Tank	45 U.S. gallons	170 liters
Cabin Headroom	6' 7"	2 m
Sleeps	4 (5 optional)	

CONSTRUCTION

- Cherry wood bulkheads, cabinetry, trim, & doors throughout cabin, with high-gloss finish
- Fabricated aluminum floor frames with stainless steel stanchions
- Hand-laid, molded fiberglass components featuring composite laminate hullsides, decks, & cabintops
- Hull bottom sandblasted in preparation for bottom paint; assures adherence and eliminates the "peeling effect"
- Molded fiberglass stringer system
- Solid fiberglass hull bottoms with Knytex substrates & Vinylester barrier coat
- Structural engine mountings - reinforced stringer mountings with double-gusseted, angle steel plates
- Tinted, tempered safety glass frameless window systems
- Unitized deck, cockpit, & cabintop construction with integral aluminum truss reinforcement in cabintop structure

MECHANICAL

- Carver Docking System™ - Inboard engines receive 6 hp, 7.3" (18,5 cm) diameter Side Power® bow & stern thrusters providing 176 lbs. (80 kg) of thrust; Volvo IPS engines receive IPS Joystick Control
- Cutlass bearings - synthetic rubber composite
- Dripless shaft logs
- Exhaust mufflers - engines, generator
- Fresh water cooling - engines
- Fuel tanks (2) - 167 gallons (632 L) each, welded, baffled 5052 aluminum
- Hydraulic steering
- Internal seawater strainers
- Propellers - 4-blade, Certifiable Manganese Bronze, 20" (51 cm) diameter, manufacturer-certified
- Propeller shafts - Aquamet®, 1.5" (38 mm) diameter
- Rudders & struts - 421 manganese bronze
- Tides Marine® SureSeal Shaft Seals - self-aligning Nitrile lip seal, maintenance free, spare lip seal included
- Trim tabs - stainless steel, hydraulic

ELECTRICAL

- AC/DC distribution panels with magnetic circuit breakers & integral bilge blower controls; AC & DC voltmeters; AC ammeter
- Batteries (4) - 31 series starting batteries, Dekka Marine®, cold cranking rating of 950 amps, reserve capacity of 205 minutes at 23 amp draw, 100 amp/hour rating [(4) engine]
- Battery- dedicated 31 series, Dekka Marine®, deep cycle, (12V), cold cranking rating of 950 amps, reserve capacity of 225 minutes at 23 amp draw, 105 amp/hour rating [(1) ship service]
- Battery charger - (1) 60 amp charger for the engines and ship service batteries
- Dockside inlet - CATV with 50' (15,2 m) of white cord
- Ground Fault Circuit Interrupt (GFCI) protection - all electrical outlets
- Shore power connector - 30 amp
- Shore power cord (1) - Marincor® 50' (15,2 m) white
- Wiring system - tinned copper strand wire, harnessed, color-coded, labeled, meets or exceeds ABYC standards

ENGINE ROOM

- Bilges coated with white, low-VOC gelcoat
- Bulkheads laminated to hull sides & stringers
- Insulation - acoustical and thermal, vinyl vapor barrier
- Lights (5) - 3 fluorescent, 2 halogen (*in aft bilge*), overhead, controls mounted in salon

*Standard

SAFETY & NAVIGATION

- 65-5-5-5 marine grade bronze seacocks for thru-hulls on hull bottom; marine grade composite on hull sides
- Anodes - zinc, sacrificial
- Battery master disconnect switches
- Battery restraint boxes & straps
- Bilge alarm - high water
- Bilge blowers (4) - 4" at 240 cubic foot/minute (12V) (10 cm at 6,8 cubic meter/minute)
- Bilge pumps (3) - 1500 gallons (5678 L) per hour each, automatic/manual operation
- CO detectors in salon & staterooms
- Compass - Ritchie® Navigator 4.5" (11,4 cm) Flush Mount, illuminated, dual-read
- Engine alarms - temperature & oil pressure
- Fire suppression system - automatic, FE241
- Galvanic isolator/zinc saver
- Horn - dual electric (12V), trumpet
- Internal bonding system with size 8 gauge wire, ABYC compliant
- Molded nonskid surfaces on all walk decks - diamond pattern
- Navigation lights (COLREGS)
- Spotlight - ITT Jabsco®
- Windlass

COCKPIT

- 92 ft² (8,5 m²) approx., integral to hull & deck, self-draining
- Boarding access from port or starboard dock
- Command bridge stairway - integral to deck with stainless steel hand rail, overhead stainless steel grab rail, 3 courtesy lights
- Electrical outlet
- Hatch - guttered, supported by gas shock, provides aft bilge access
- Lights (3) - courtesy, recessed, with exterior-mounted switch
- Lights (2) - halogen, overhead, recessed, with exterior-mounted switch
- Side deck stairways (2) - integral to deck with grab rail, 2 courtesy lights
- Storage lockers (2) - recessed in sole
- Transom door - fiberglass, secures open & closed, stainless steel hardware

DECKS

- Bow rail - 1.0" (2,5 cm) O.D., lineal-buffed, welded stainless steel, with additional intermediate rail amidships & forward
- Bow rail stanchions - double-welded (*inside & outside*), stainless steel, anchored to aluminum backing plates laminated into deck
- Cleats - 10" (25 cm) stainless steel: anchor (1), bow (2), spring (4), stern (2) - bolted through aluminum backing plate
- Deck toe rail
- Grab rails (2) - stainless steel, on cabin sides
- Over-the-stem anchor roller
- Rub rail molding - heavy-duty, 1" & 3/4" 316L stainless steel insert (25 mm & 19 mm)

WATER & HOLDING SYSTEMS

- Fresh water storage tanks - polyethylene; (1) 75 gallon (284 L) with v-drive engines; (2) 43 gallon with Volvo IPS engines (163 L)
- Fresh water tank level monitor
- Hot & cold transom handshower
- ITT Jabsco® Fresh Water System - variable speed drive pump sensor, Max®, 4.5 gallon/minute (17 liters/minute) flow rate, high flow filter
- Shore water connection with pressure-reduction valve
- Shower sump pump (1) - automatic/manual operation
- Waste holding tank (1) - 45 gallons (42 L) with filtered vent & dockside pumpout
- Waste tank level monitor
- Water & waste lines - constructed of molecularly cross-linked polyethylene
- Water heater - 11 gallons

*Standard

HELM

- Accessory space - for installing navigation equipment
- Adapter - 12V
- Beverage holders (2) - self-draining
- Companion helm seat - swivel pedestal, high-quality marine-grade upholstery, embroidery stitching, and arm rests
- Dash - molded fiberglass with brushed aluminum accents
- DC circuit breaker panel for helm electronics
- Displays (1 for each engine) - digital LCD; tachometer, hourmeter, engine oil pressure, engine coolant temperature, engine battery voltage, fuel usage, fuel trip usage, engine diagnostics
- Gauges - analog; fuel level and rudder angle (1 for each engine)
- Grab rail - stainless steel, behind helm & companion seats
- Helm seat - swivel pedestal, high-quality marine-grade upholstery, embroidery stitching, and arm rests
- Rocker switch controls
- Stereo speakers (2)
- Tilt steering wheel

BOARDING PLATFORM

- 35 ft² (3.3 m²) approx., integral to hull & deck
- Boarding ladder - telescoping, conceals in boarding platform

DINETTE

- Carpet - tufted cut pile, crush-resistant, 100% nylon
- Curtains - décor-matched
- Lights (4) - halogen, overhead, recessed
- Lounge - L-shaped
- Rocker light switch
- Table - cherry wood top; 2 brushed aluminum legs

COMMAND BRIDGE

- Access panel - behind lounge backrest, provides access to helm wiring
- Electronics arch - welded premium grade aluminum painted with AWLCRAFT® 2000 acrylic urethane topcoat for use in harsh marine environments
- Electronics arch access plates (5) - corrosion-resistant polymer attached with noncorroding screws & waterproof sealant
- Lights (2) - courtesy, recessed, with exterior-mounted switch
- Lounge - with storage beneath, accommodates 4 adults
- Self-draining walk surface
- Storage lockers (2)
- Table - molded fiberglass, sliding, in front of lounge
- Wet bar - molded fiberglass, integral self-draining sink, cold water tap, 2 storage cabinets beneath
- Windshield - wraparound, tinted glass, painted stainless steel frame

GALLEY

- Coffee maker - Black & Decker®, black (110 V only)
- Countertops - solid surface, with stainless steel sea rail in polished & brass finishes
- Curtains - décor-matched
- Designer décor
- Electrical outlet
- Flooring - Cherry
- Lights (2) - halogen, overhead, recessed
- Microwave oven - convection with grill, built-in
- Range - electric, 2-burner, glass top
- Refrigerator/freezer - Nova Kool®, 7.5 cubic foot (212 L), stainless steel, side-by-side under-counter
- Rocker light switches
- Silverware tray
- Sink - stainless steel, with solid surface cover
- Stereo speaker
- Storage cabinets (3)
- Storage drawers (4)
- Vent fan - above range
- Waste container - 9 quart, round, white

*Standard

SALON

- Carpet - tufted cut pile, crush-resistant, 100% nylon
- Countertops - cherry wood with sea rail
- Curtains - décor-matched
- Décor package - 5-piece decorator pillow set
- Designer décor
- Electrical outlet
- Entertainment group - 20" Sole® LCD TV (built to durable marine grade standards), Clarion® CMD4 AM/FM/CD waterproof marine stereo, Clarion® DVD/CD/MP3 player, Sirius® satellite radio system with 6 month trial subscription & Apple iPod® Dock
- Entrance door - tinted glass, aluminum frame, curved, sliding, handle lock, 2 deadbolts, with interior screen
- Floor access hatches - engine room
- Lights (3) - halogen, overhead, recessed
- Rocker light switches
- Sofa - Flexsteel®, with storage beneath
- Stereo speaker
- Storage cabinets (3)

HEAD

- Clothes hook & towel ring
 - Electrical outlet
 - Entrance doors (2) - one to master stateroom & one to galley, solid cherry wood, secure closed, stainless steel hardware
 - Hardware highlights - brass/chrome
 - Head fan
 - Hull portlight - frosted privacy glass, with screen
 - Lights (2) - halogen, overhead, recessed
 - Medicine cabinet - mirrored doors, 2 shelves with sea rails
 - Nonskid sole
 - Rocker light switch
 - Skylight
 - Vanity - granite-style top & backsplash, integral sink, storage beneath with 2 doors
- ### **Shower Stall / Water Closet**
- Countertop - granite-style
 - Lights (2) - halogen, overhead, recessed
 - Nonskid sole
 - Shower door - clear acrylic in aluminum frame, bi-fold, secures open & closed, stainless steel hardware, matching sidelights
 - Shower head - removable for use as hand-shower
 - Storage cabinets (2)
 - Toilet - VacuFlush®, pedestal
 - Toilet paper holder & towel bar

*Standard

MASTER STATEROOM

- Berth - queen, pillowtop innerspring mattress
- Berth step-ups (2) - carpeted
- Carpet - tufted cut pile, crush-resistant, 100% nylon
- Curtains - décor-matched
- Designer décor
- Electrical outlet
- Entrance door - solid cherry wood, pocket-style, secures open & closed, stainless steel hardware
- Hanging lockers (2) - automatic light, 3 shelves in each with sea rails
- Hull portlights (2) - fixed, non-opening
- Lights (3) - halogen, overhead, recessed
- Lights (2) - halogen, overhead, directable for reading
- Mirror - on forward bulkhead, conceals anchor chain locker access
- Overhead hatch - tinted, lockable, inside screen
- Private head access
- Rocker light switches
- Stereo speakers (2)
- Storage cabinets (7)
- Storage drawer
- Surround shelves - cherry wood with sea rail

VIP STATEROOM

- Berth - double, converts to twins with removable center filler, with berth covers
- Carpet - tufted cut pile, crush-resistant, 100% nylon
- Countertops - cherry wood
- Curtains - décor-matched
- Designer décor
- Electrical outlet
- Entrance door - solid cherry wood, split, pocket-style, secures open & closed, stainless steel hardware
- Hull portlight
- Lights (4) - halogen, overhead, recessed
- Light - halogen, scone, directable for reading
- Rocker light switch
- Shelves (2) - cherry wood, recessed
- Storage - beneath mattress
- Storage cabinets (3)

COMPANIONWAY

- AC & DC distribution panels
- Carpet - tufted cut pile, crush-resistant, 100% nylon
- Countertop - cherry wood with sea rail
- Curtains - décor-matched
- Hand rail - stainless steel, on stairway
- Hull portlight - with screen
- Lights (2) - courtesy, recessed
- Rocker light switch
- Storage cabinet - with sliding, curved, cherry wood tambour door

*Standard

PROPULSION:

Gasoline Engines

- Crusader® 6.0 MPI - 375 hp* (includes fresh water cooling)
- Crusader® 8.1 MPI - 385 hp (includes fresh water cooling)
- Volvo Penta® IPS 550 - (gas) 400 hp

Diesel Engines

- Yanmar Marine® 6LPA-STP - 315 hp
- Volvo Penta® D4 EVC - 300 hp
- Volvo Penta® D6 EVC - 370 hp
- Volvo Penta® IPS 450 - 330 hp

MECHANICAL:

- Engine oil change system
- Active corrosion protection for Volvo IPS - replaces traditional zinc anodes, triple redundant protection, integrates with EVC displays; monitors & adjusts potential voltage in surrounding water to an acceptable level

ELECTRICAL:

- Air conditioning - Marine Air Systems®, 2-zone, 32,000 BTU; with reverse cycle heat; dedicated Marinco® shore power connector

- Generator** (with sound shield, dedicated 31 series battery and 10 amp battery charger)
- Kohler® 7.3 kW 60 Hz gasoline

- Kohler® 6 kW 50 Hz gasoline international
- Kohler® 9 kW 60 Hz diesel
- Kohler® 7 kW 50 Hz diesel international

WATER & HOLDING SYSTEMS:

- After tank overboard discharge system with pump
- Grey water holding system - (1) grey water holding tank

Transom & Bow Washdowns

- Fresh water
- Seawater
- Both fresh & seawater

SAFETY & NAVIGATION:

- Fender racks
- Ground tackle - 35 lb. (16 kg) anchor, 125' (38 m) of 5/16" 8 mm chain, shackle & line with snap hook
- SeaKey® - satellite based boat security, safety & concierge system; 90 day trial subscription (U.S. & Canada only)

Navigation Electronics Package

- Bridge Package - Raymarine® E-Series E80 multifunction navigation display, Raymarine® 240 VHF (hand set), 125 WASS GPS sensor, Raymarine® DSM 300 digital sonar module, Raymarine® transducer B60 Dual Frequency 50/200 khz depth & temperature

Spare Propellers & Shaft

- Spare propellers (2) & shaft

AMENITIES:

Bridge layout

- Helm aft - ideal for fishing
- Helm forward* - ideal for cruising

Canvas

- Prestige bimini top
- Prestige full canvas with carpet

Canvas Color

- Black Sunbrella®
- Cadette Grey
- Captain's Navy
- Charcoal Tweed
- Toast
- White Stamoid®*

Exterior

- Bridge cover
- Bridge hardtop
- Bridge hardtop enclosure
- Bridge lounge slip covers & pillows
- Cockpit to Bridge door
- Exterior carpet - berber (color coordinated with exterior seating upholstery color selection)
- Fishing package - Cockpit livewell with Rule® pump, Perko® vertical rod holders on transom (4), Perko® rod holders (2), C.E. Smith® mid mount "rocket launcher" rod holders (5)
- Foredeck sunpad
- Helm & seat covers

- Ice maker - U-Line®, produces up to 23 lbs. (10 kg) of ice per day (not available with Helm Forward)

- Underwater lighting

Salon

- Clarion® 6-disc CD changer
- Pillow set - decorator, 6-piece
- Surround sound system with Kenwood® touchscreen stereo (U.S. & Canada only)

Salon Sofa

- Storage*
- Double incliners
- Stowaway bed

Master Stateroom

- 15" Sole® LCD TV (built to durable marine grade standards) & Clarion® DVD/CD/MP3 player
- Sheet & towel sets embroidered with Carver® logo - fitted sheet, flat sheet, & 2 pillow cases per stateroom; 2 bath towels, 2 hand towels, 2 washcloths

EXTERIOR PAINT:

Hull Paint Application

- Paint to Hull Plank
- Paint to Mid-Hull
- Paint on Full Hull

Hull Paint Color

- (with matching boot stripe)
- Carver Blue (a blue steel metallic)
- Navy Blue

Painted Boot Stripe Color

- Black*
- Blue
- Carver Blue - included with Carver Blue exterior paint options
- Navy Blue - included with Navy Blue exterior paint options

DECOR:

Ensemble

- Cocoa Beach* (dark & light brown tones)
- Ensign Blue (blue & brown tones)

Upholstery

- Buff*

Countertops

- Bahamas Sand*
- Expression

EXTERIOR SEATING UPHOLSTERY COLOR

- Gray*
- Taupe

INTERNATIONAL SPECIFICATIONS

- 220 volt electrical system
- Entertainment equipment & options may not be available outside the U.S. & Canada. Check with your local Carver dealer for availability.
- Sirius Satellite radio not available

*Standard

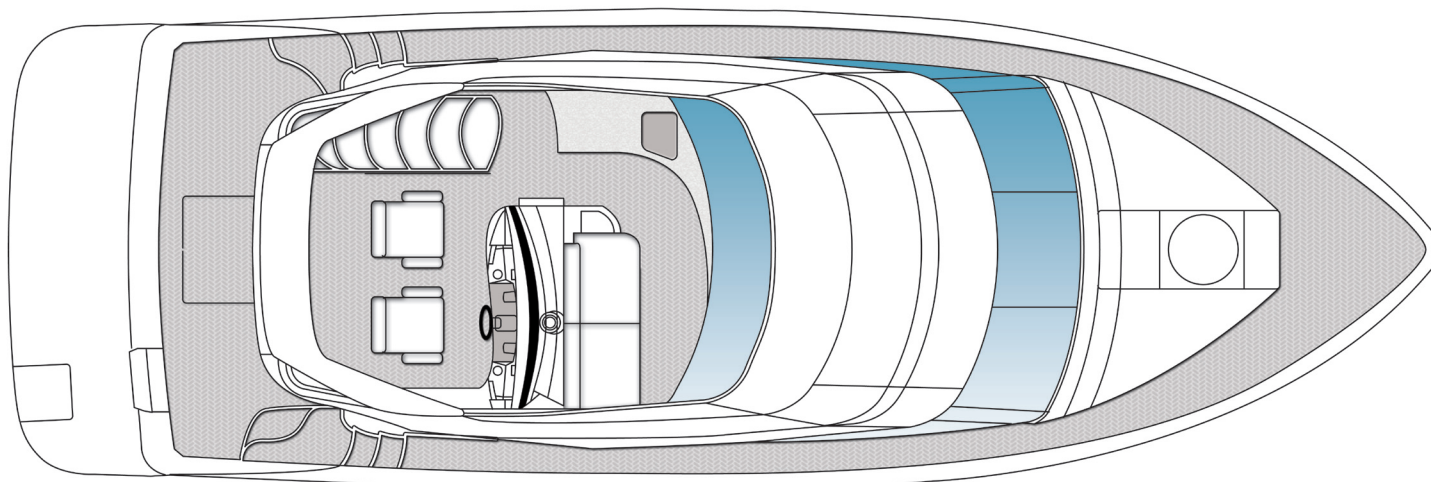

Helm Forward

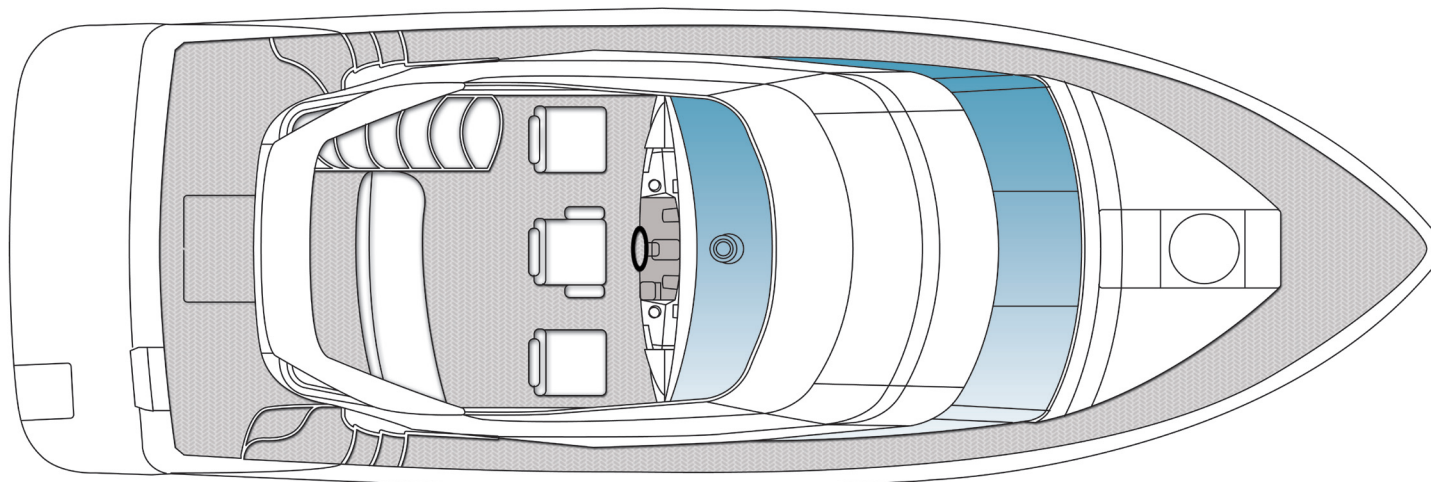

Helm Aft

Carver Yachts reserves the right to change price, colors, materials, equipment specifications or models without notice. All specifications and measurements are approximate and subject to change. Models may be discontinued without obligation to previous purchasers. Illustrations may include optional equipment. Some electrical equipment is only offered in 120V/60Hz; check with your Carver Dealer for availability outside the U.S.

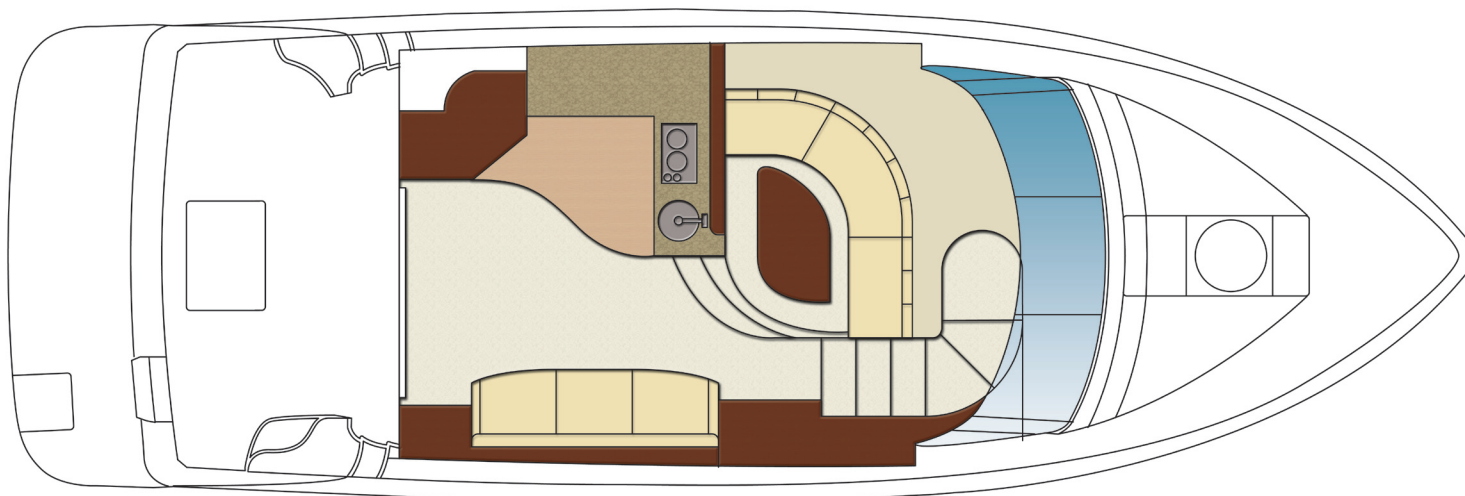

Main Deck

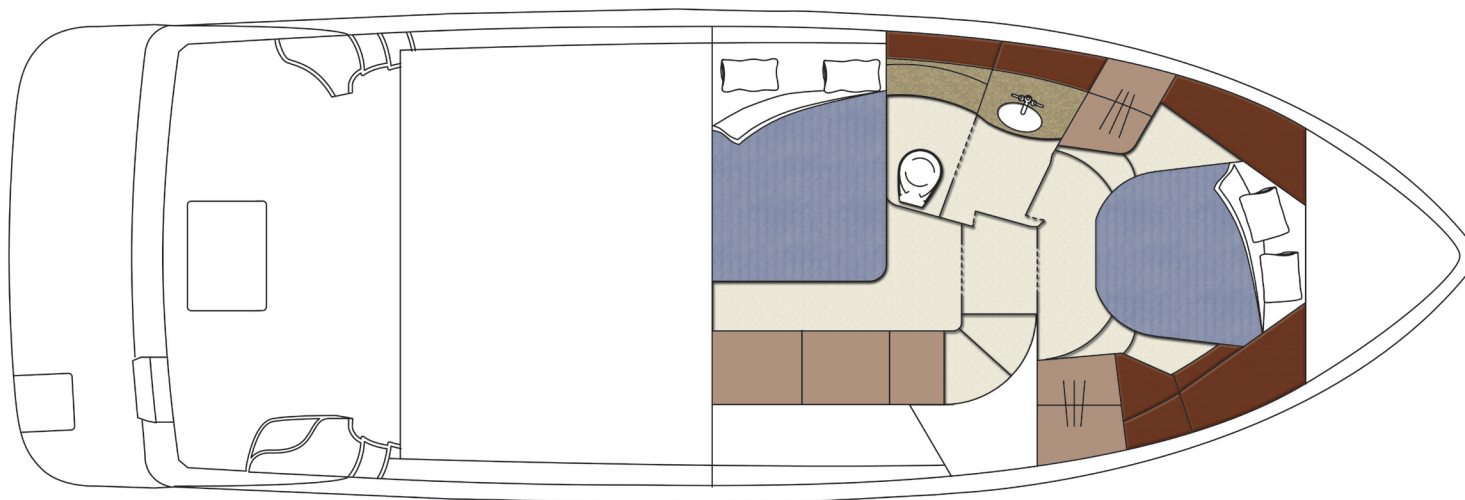

Lower Deck