

MARQUIS

SPECIFICATIONS

690 MARQUIS

Design & Styling: Nuvolari Lenard Naval Architecture, Venice, Italy • Crafted by Marquis Yachts, USA

NUVOLARI  LENARD™



KEY SPECIFICATIONS

LOA [with platform & gunnel molding]	69'11"	21.3 m
Beam [with gunnel molding]	17'11"	5.5 m
Draft [with CAT 18 Engines]	5'4"	1.6 m
Weight [with full fuel & water]	102,000 lbs	46,267 kgs
Bridge Clearance [top mast head light with full fuel & water]	24'5"	7.4 m
Fuel System		
Standard	1,200 U.S. gals.	4542 liters
With Additional Capacity	1,400 U.S. gals.	5300 liters
Water System	200 U.S. gals.	757 liters
Holding System		
Standard	116 U.S. gals.	580 liters
With Crew Quarters	151 U.S. gals.	556 liters
Cabin Headroom	6'8"	2.0 m
Sleeps	8	



MARQUIS

SPECIFICATIONS

690 MARQUIS

Construction

- **Bulkheads, cabinetry & mouldings:** open grained, select oak hardwood throughout cabin
- **Cabinetry:** marine-type with doweled & dove-tailed joints, metallic joint reinforcements, stainless steel & silicon bronze fasteners, custom fit
- **Hull sides, cored:** fiberglass encapsulating high-density foam core below the waterline & endgrain balsa core above the waterline
- **Deck plate:** 1.75" (4.4 cm) tubular aluminum rails & 1.75" (4.4 cm) endgrain balsa core encapsulated in fiberglass; mechanically fastened & laminated to hull sides around entire circumference; comprises fore deck, side decks & cockpit sole, & main cabin under-sole
- **Hull bottom:** solid fiberglass with Knytex substrates; sandblasted in preparation for bottom paint assures adherence and eliminates the "peeling effect"; vinylester barrier coat
- **Steering shelves:** (2) 0.5" (1.2 cm) aluminum plates
- **Stringer system:** molded fiberglass grid on hull sides & bottom, high-density foam core
- **Structural engine mountings:** linear span, longitudinal rail system with multiple-gusseted steel plates bolted through reinforced, high-density foam-cored stringer members
- **Superstructure:** unitized flybridge & deck house construction, self-supporting, aluminum truss cage system configured as monocoque structure, welded to base frame of aluminum bar stock, mechanically fastened to main cabin upper-sole (1.75" (4.4 cm) tubular aluminum rails & 1.75" (4.4 cm) endgrain balsa core encapsulated in fiberglass), assembly bolted to deck plate through drilled-&-tapped reverse flange mount reinforced with aluminum bar stock
- **U.S. Navy-style construction** with hull & deck plate forming integrated structural element, "boxed-beam" reinforcement with minimum 1" (2.5 cm) thick structural bulkheads triple-bonded on their circumference
- **Window systems:** frameless; tinted, tempered safety glass flange-mounted with urethane adhesive/sealant; supported by aluminum truss system

Mechanical

- **Air conditioning:** Cruisair® split system in cabin, 4-zone, 80,000 BTU; with reverse cycle heat & heater strips; dedicated Marinco® shore power connector
- **Cutlass bearings:** synthetic rubber composite
- **Shaft logs:** dripless with spare seals on shaft
- **Exhaust mufflers:** engines, generator
- **Fresh water cooling:** engines & generator
- **Fuel tanks:** (2) 600 gallons (2271 liters) each, welded, baffled 5052 aluminum
- **Hull portlights:** 10" x 21" (25 cm x 53 cm), screened, multiple latches
- Hydraulic steering
- **Marquis Docking System™** includes 13 hp, 9.8" (25 cm) diameter Side Power® bow & stern thrusters providing 507 lbs. (230 kgs.) of thrust with wireless docking remote control
- Power steering
- **Propellers:** 5-blade, Certifiable Alloy NiBrAl, 38" (97 cm) diameter, manufacturer-certified
- **Propeller shafts:** Aquamet®, 3.5" (9 cm) diameter
- **Rudders & struts, primary & secondary:** 421 manganese bronze
- Seawater strainers
- Ship's systems control panels in engine room
- **Shaft Seals:** Tides Marine® SureSeal self-aligning Nitrile lip seal, maintenance free, spare lip seal included
- **Trim tabs:** stainless steel, electric: 4 ea. 36x9

MARQUIS

SPECIFICATIONS

690 MARQUIS

Electrical

- **AC/DC distribution panels** with PLC-controlled circuit breakers & integral generator controls; AC digital voltmeters & ammeters, DC digital multimeter
- **Batteries, engine starting & ship service:** (8 total) Douglas, 8D series, marine (12V) cold cranking rating of 1375 amps, reserve capacity of 430 minutes at 25 amp draw, 200 amp/hour rating [(4) engine starting, (4) ship service]
- **Battery, generator:** (1) dedicated 31 series Deka Marine®, deep cycle (12V), cold cranking rating of 950 amps, reserve capacity of 225 minutes at 23 amp draw, 100 amp/hour rating [generator]
- **Battery chargers:** (5) electronic, AC-DC converters [(2) 75 amp for engine batteries, (1) 25 amp for generator, (1) 100 amp for ship service, (1) 120 amp from inverter]
- Cablemasters: dual
- **Courtesy lights:** incandescent
- **Dockside inlet:** CATV with 50' (15.2 m) of white cord
- **Generator:** 23 kW 60 Hz (20 kW 50 Hz internationally), Kohler® with sound shield, dedicated 31 series battery, 5 year warranty, premium electrical system, & remote power source control
- **Ground Fault Circuit Interrupt (GFCI) protection:** all electrical outlets
- **Inverter:** DC to AC electrical on select appliances
- **Isolation transformers** on the internal shore power lines
- **Overhead lights:** 18W (10W), Xenon®, brushed aluminum bezel
- **Shore power connectors:** (2) 50 amp (32 amp 220 V), white
- **Shore power cords:** (2) Marinco® 75' each, 50 amp (32 amp 220 V), white
- **Wiring system:** tinned copper strand wire, harnessed, color-coded, labeled, meets or exceeds ABYC standards

Engine Room

- AC & DC distribution panels
- **Bilges:** coated with white, medium-gloss gelcoat
- **Bulkheads:** laminated to hull side & hull bottom stringers
- **Catwalk:** polished diamond plate
- **Cockpit hatch access ladder:** stainless steel, nonskid steps
- Electrical outlet
- **Entrance hatches:** (2) dual access (cockpit & storage lazarette/optional crew quarters)
- **Insulation:** SoundDown®; perforated marine-grade 5052 aluminum surface with polyester-epoxy hybrid powder coat face & nonwoven acoustic material backing; sublayers of 1" (2.5 cm) fire-retardant foam with metalized mylar vapor barrier face, 2-lb./ft² (9.7 kg/m²) vinyl acoustic barrier, 1" (2.5 cm) fire-retardant foam
- **Lights overhead, fluorescent:** (5) controls in cockpit & storage lazarette/optional crew quarters
- **Surface panels:** aluminum, perforated, white

MECHANICAL COMPARTMENTS (2: PORT & STARBOARD AFT)

- **Access doors:** (2) in lazarette storage/optional crew quarters
- **Bilges:** coated with white, medium-gloss gelcoat
- **Bulkhead:** laminated to hull sides & stringers
- **Catwalk:** polished diamond plate
- **Light overhead, fluorescent:** controls in cockpit & storage lazarette/optional crew quarters

MARQUIS

SPECIFICATIONS

690 MARQUIS

Water & Holding Systems

- Central grey water drain system
- **Fixtures:** imported custom taps/spigots, combination polished chrome/nickel finish
- **Fresh water storage tank:** (1) 200 gallons (757 liters), stainless steel
- Fresh water tank level monitor
- **Grey water sump pump:** (1) automatic/manual operation, 3700 gallons (14000 liters) per hour, automatic operation; 1100 gallons (4163 liters) per hour
- **Pump fresh water system:** Grundfos® pressurized (110V or 220V), with dual filters
- **Handshower:** fresh water, hot & cold, in transom
- **Plumbing:** flexible lines constructed of molecularly cross-linked polyethylene; rigid lines constructed of PVC
- **Shore water connection** with pressure-reduction valve
- **Washdown:** fresh water, 1 at bow & 2 at transom
- **Waste holding tanks:** (2) (1) 77 gallon (291 liters) & (1) 76 gallon (288 liters), polyethylene, with filtered vents & dockside pumpouts
- Waste tank level monitors (4)
- **Water heaters:** (2) 16 gallons (60.5 liters) each (110V or 220V)

Decks

- **Anchor plate:** polished stainless steel, with stainless steel clad recessed anchor channel & nylon rollers
- Beverage holder recess
- **Bow rail:** 1.25" (3.1 cm) O.D., lineal-buffed, 316 stainless steel
- **Bow rail stanchions:** double-welded (inside & outside), 316 stainless steel, anchored to aluminum backing plates laminated into bulwark
- **Bulwark:** fiberglass
- **Drain grates:** (2) polished stainless steel, with insignia
- **Engine room air vents:** concealed in superstructure
- **Gutters:** (2) port & starboard, direct water from canted walk surface to grated trap, then overboard
- **Hawse pipes:** (2) polished stainless steel, port & starboard
- **Lights, minispot-lights:** (6) 18W Xenon®, illuminate cabin & bridge sides
- **Lights, accent:** courtesy, recessed, LED
- **Lights, overhead, recessed:** (6) LED
- **Locker:** contains TV & optional shore power connectors; fresh & optional raw water washdowns; polished stainless steel hardware; gull-wing door supported by gas shocks; in superstructure forepeak
- **Lockers, in-deck:** (2) fender & line, polished stainless steel hardware, self-draining
- **Lockers, in superstructure:** (2) fender & line, polished stainless steel hardware, gull-wing doors supported by gas shocks, self-draining
- **Mooring cleats:** (2) bollard-style, stainless steel, bolted through aluminum backing plate, inboard-mounted
- Pilothouse door: manual
- **Rub rail molding:** high-impact, heavy duty, 1" (2.5 cm) 316L stainless steel insert
- Side deck access doors: port & starboard
- **Spring cleats:** (4) bollard-style, stainless steel, bolted through aluminum backing plate
- **Sunpad:** double
- **Windshield weather covers:** black mesh

MARQUIS

SPECIFICATIONS

690 MARQUIS

Safety & Navigation

- **Seacocks:** 65-5-5-5 marine grade bronze for all underwater thru-hulls
- **Anodes:** zinc, sacrificial
- Battery master disconnect switches
- Battery boxes & covers with restraint straps
- **Bilge alarm:** high water
- **Engine room blowers:** (1) 4200 cubic ft. minute, (1) 250 cubic ft. minute
- **Bilge pumps:** (9) 3700 gallons (14,000 L) per hour each, automatic/manual operation (24V)
- **CO detectors** throughout cabin & in optional crew quarters
- **Compass:** Ritchie® Navigator 4,5", (11.4 cm) flush mount, illuminated, dual-read
- **Docking lights:** transom
- **Engine alarms:** temperature & oil pressure
- **Fire suppression system:** automatic, FM240
- **Flagstaffs:** (2) bow and stern
- **Fuel alarm lights:** (2) indicate water in fuel
- Galvanic isolator/zinc saver
- **Horns:** dual air trumpet
- **Internal bonding system** with size 8 gauge wire
- **Molded nonskid surfaces** on all walk decks: diamond pattern
- Navigation lights (COLREGS)
- **Spotlight:** ACR 100D, dual light
- **Windlass package:** Maxwell® 4000 with 75 lb. (34 kg) stainless steel plow anchor & 300' (91.4 m) of 3/8" (9.5 mm) grade 40 chain
- High engine exhaust temperature alarm

Cockpit

- **Bridge stairway:** integral, 10" (25 cm) risers (meets residential standards), with stainless steel hand rails, diamond pattern non-skid steps, 3 recessed courtesy lights
- **Cockpit:** 114 ft² (10.5 m²) approx., fully guttered & self-draining
- Electrical outlet
- **Emergency fire suppression system** controls: in starboard transom corner locker
- **Engine room hatch:** guttered, watertight, polished stainless steel hardware, supported by gas shocks
- **Fairleads:** (2) polished stainless steel, port & starboard
- **Lights courtesy, recessed:** (4) with exterior-mounted switch
- **Lights, overhead, recessed:** (9): with exterior-mounted switch
- **Lockers, in transom corners:** (2) storage
- **Lockers, in port & starboard bulwark** (2): fresh & optional raw water washdown in each, hand-shower in starboard, self-draining
- **Lounge:** ultraleather upholstery, accommodates 6 adults, across transom, with cover
- **Mooring cleats:** (2) bollard-style, stainless steel, bolted through aluminum backing plate, inboard-mounted
- **Overhead sun/weather protection:** with mirrored bussola inset
- Stereo speakers (2)
- **Transom gates:** (2) stainless steel, Marquis™ monogrammed, with magnetic catches, at the top of the cockpit stairways

Boarding Platform

- **Boarding platform:** 107 ft² (9.9 m²) approx., hydraulically-actuated, pantographic, moves out & down, with remote control
- **Boarding ladder:** telescoping, with grab rail, concealed beneath platform extension
- **Bilge air exhaust vent:** concealed in transom
- **Cockpit stairways:** (2) integral to deck
- **Mooring cleats:** (2) bollard-style, stainless steel, bolted through aluminum backing plate
- **Grab rails:** (2) stainless steel, on transom
- **Teak decking:** inlaid, 3/8" (9.5 mm) plank

MARQUIS

SPECIFICATIONS

690 MARQUIS

Command Bridge

- **Aft bridge extension:** 76 ft2 (7 m2) approx., self-draining, with toe rail
- **Bar:** curved, translucent solid surface countertop with under-lighting, stainless steel foot rail, cabinet beneath with bottle holders
- **Beverage holders:** (8) stainless steel, self-draining
- **Cabinet:** fiberglass, starboard side
- **DC distribution panel:** bridge 12V systems
- Electrical outlets
- **Electronics arch:** welded premium grade aluminum painted with AWLCRAFT® 2000 acrylic urethane topcoat for use in harsh marine environments
- **Electronics arch access plates:** (7) corrosion-resistant polymer attached with noncorroding fasteners & waterproof sealant
- **Entrance door:** stainless steel frame with tinted tempered glass, interior & exterior grab handles & latch handles, keyed deadbolt, weather-tight, provides access to cabin
- **Lights, accent, courtesy:** recessed under bar
- **Lights, courtesy, recessed:** (7 total), (5) with exterior-mounted switch, LED
- **Lights, recessed:** in electronics arch, with exterior-mounted switch
- **Lounge:** command bridge, U-shaped, ultraleather upholstery, accommodates 8 adults, with storage beneath
- **Safety rail:** 1.25" (3.1 cm) O.D., lineal-buffed, 316 stainless steel, with intermediate rail, around cockpit stairway opening
- **Safety rail stanchions:** double-welded (inside & outside), 316 stainless steel, anchored to aluminum backing plates laminated into deck
- Self-draining walk surface
- **Stereo speakers:** (2) in electronics arch, pre-wired
- **Table:** wood and acrylic top, highly polished stainless steel, and pedestal base
- **Wet bar:** solid surface countertop, under-mounted sink with cold water faucet, 2 storage cabinets beneath, angular, translucent solid surface countertop with under-lighting, stainless steel foot rail, cabinet beneath with bottle holder

Fly Bridge Helm and Lower Helm

- **Air vents:** (3) 2 directable, 1 fixed
- **Access doors:** (3) provide access to systems & wiring below helm
- **Access panel:** provides access to wiring below helm
- **Accessory space:** for installing navigation electronics
- **Adapter:** 12V
- **Beverage holders:** (3) stainless steel, self-draining
- **Companion helm seats:** (2) swivel pedestal, high-quality elegant upholstery, embroidery stitching, and arm rests
- **Dash:** wraparound fiberglass with brushed aluminum accents
- **Displays:** (1 for each engine): digital LCD; engine instrumentation and diagnostics
- **Emergency controls:** shift & throttle
- **Gauges:** analog; rudder angle, fuel level (1 for each tank)
- **Helm seat:** swivel pedestal, high-quality elegant upholstery, embroidery stitching, arm rests, flip-up seat bolster, adjustable height, stitched Marquis™ Yachts icon
- **Lights, courtesy, recessed:** (2) LED
- Rocker-type panel switches
- **Stereo speakers:** (2) pre-wired
- Tilt steering wheel
- **Windshield:** tinted, wraparound, stainless steel frame
- Venturi air deflector
- **Night navigation reading light:** red, over helm

MARQUIS

SPECIFICATIONS

690 MARQUIS

Salon

- **AC & DC distribution panels:** concealed, hinged
- **Carpet:** patterned cut & loop saxony; 100% nylon with advanced stain protection; fade-, wear-, crush-resistant; multi-year warranties; with pad
- **Cabinets:** (5) sapele pommele wood inlay top, high gloss jewel finish, with cherry wood sea rail
- **Chairs:** (4) 2 ultra-leather recliners, 2 ultra-leather swivel
- **Curtain:** décor-matched, slides horizontally in top & bottom tracks, over entrance door
- **Designer décor:** consisting of premium wall coverings & fabrics
- Electrical outlets
- **Entertainment group:** 32" (81 cm) Sole® LCD TV (built to durable marine grade standards) with electric lift, enclosed in cabinet, Sony® DVD/CD, Sony® 5.1 channel home theater receiver, Niles In-Wall® theater speakers, subwoofer, Sirius® satellite radio system & Apple iPod® dock
- **Entrance door:** stainless steel frame, fully vertical, convex, sliding, handle latch, keyed deadbolt, secures open, neutral density glass with mirrored exterior, interior sliding screen
- **Hardware highlights:** stainless steel, polished & brushed
- **Light, sconce:** brushed nickel cover
- **Lights, recessed:** (6) in soffit, with electronic dimmer control
- **Lights, overhead, recessed:** (10) with electronic dimmer control
- Rocker light switches
- **Sofa:** ultra-leather upholstery, with 2 integral storage drawers beneath
- **Soffits:** (2) cherry wood, port & starboard outboard
- **Window treatment:** roman shades with recessed headrails

Galley and Entertaining Area

- **Coffeemaker:** (1 110V only) Cuisinart®, stainless steel, recessed, on access tray
- **Countertops:** granite
- Designer décor: consisting of premium wall coverings & fabrics
- Electrical outlets
- **Flooring:** granite in galley
- **Hardware highlights:** polished stainless steel
- **Lights, overhead, recessed:** LED
- **Lights at cabinets:** recessed in bottom of overhead cabinets
- **Microwave/convection oven/broiler:** Sharp®, built-in, brushed stainless steel finish
- **Range:** full size with oven and 4-burner cooktop
- **Range hood:** brushed stainless steel, with 2 lights, exhaust fan, outside vent
- **Refrigerator/freezer:** Jenn-Air®, full-size french door, bottom freezer, brushed stainless steel finish
- Rocker light switches
- **Skylounge Dining Area:** with ultra-leather lounge, high-gloss wood table accommodating 8 adults
- **Serving bar** on starboard side with sink and storage
- **Sink:** two basin, stainless steel, undermounted
- Storage cabinets
- Storage drawers

MARQUIS

SPECIFICATIONS

690 MARQUIS

Dinette

- **Bridge stairway:** circular, polished stainless steel post & step supports, etched glass steps
- **Carpet:** patterned cut & loop saxony; 100% nylon with advanced stain protection; fade/wear/crush resistant; multi-year warranties; with pad
- **Chairs:** (6) cloth upholstery on cushioned seat
- **China cabinets:** (2) sapele pommele wood inlay top, high gloss jewel finish, double doors on each, 2 shelves inside with sea rail
- **Flatware storage:** 3 drawers inside cabinet, built-in flatware holders
- **Lights, overhead, recessed:** (9) with electronic dimmer control
- **Table:** cherry wood herringbone pattern top, cherry wood pedestal base
- **Window treatment:** roman shade with recessed headrail

Foyer

- **Alcove:** open-grained select oak hardwood
- **Light, overhead, recessed:** (1) LED
- **Flooring:** Italian marble, stylized black granite bussola inset, carpet edging & on stairway
- **Handrail:** stainless steel, on stairway
- **Lights, courtesy, recessed:** (4) LED
- **Lights, overhead, recessed:** (2) LED
- Rocker light switches
- **Stairwell trim:** cherry wood, bolster with ultraleather upholstery
- Wall covering: silk/cotton blend

Master Stateroom

- **Berth:** "California King," pillowtop inner-spring mattress, island, with ultraleather upholstered headboard & bolsters around berth
- **Berth nightstands:** (2) cabinet beneath
- **Bulkhead architectural feature:** upholstered framed mirror with accent lighting behind mirror
- **Cabinets:** (2) open-grained select oak hardwood, marble sole accent
- **Carpet:** patterned cut & loop saxony; 100% polypropylene with advanced stain protection; fade/wear/crush resistant; 35 oz.; multi-year warranties; with pad
- **Designer décor:** consisting of premium wall coverings & fabrics
- **Dresser:** 4 drawers, open grained, select oak hardwood
- Electrical outlets
- **Entrance door:** select oak hardwood, secures open & closed, stainless steel hardware
- **Lights, accent:** recessed under berth & cabinets
- **Lights, recessed:** (15 total) LED
 - (3) over entry dais, with electronic dimmer controls
 - (3) in soffit over berth head, with electronic dimmer control
 - (3) in starboard soffit, with electronic dimmer control
 - (3) over entry dais cabinet
 - (3) over bulkhead architectural feature
- **Lights, sconce:** (2): by Cantalupi® of Viareggio, Italy
- **Lights, with electronic dimmer controls:** (10) LED
- **Mirror:** beveled edges, above entry cabinet
- **Overhead architectural feature:** wood with Nuvolari-Lenard inlay design
- Rocker light switches
- **Sheet set embroidered with Marquis™ logo:** fitted sheet, flat sheet, two pillow cases
- **Sofa:** ultraleather upholstery
- **Soffit:** oak wood grille, around stateroom perimeter
- **Windows:** (6) fixed hull, 12" (30 cm) opening port
- **Window treatments:** roman shades with recessed headrails

WALK-IN CLOSETS (2)

- **Carpet:** patterned cut & loop saxony; 100% polypropylene with advanced stain protection; fade/wear/crush-resistant; 35 oz.; multi-year warranties; with pad
- **Drawers** (2) recessed
- **Entrance doors:** solid oak wood, stainless steel magnetic door catches
- **Hull portlight:** with screen
- **Lights:** overhead, recessed, automatic operation
- **Storage cabinet:** recessed

MARQUIS

SPECIFICATIONS

690 MARQUIS

VIP Stateroom

- **Berth:** queen-size, pillow-top inner-spring mattress, island, with Ultraleather upholstered bolsters around berth
- **Berth nightstands:** (2) 3 cabinets beneath
- **Berth step-ups:** (2) carpeted
- **Bulkhead architectural feature:** upholstered vertical panels with stainless steel vertical details
- **Carpet:** patterned cut & loop saxony; 100% polypropylene with advanced stain protection; fade/wear/crush-resistant; 35 oz.; multi-year warranties; with pad
- **Designer décor:** consisting of premium wall coverings & fabrics
- Electrical outlets
- **Entrance door:** solid oak wood, secures open & closed, stainless steel hardware
- **Hardware highlights:** stainless steel, polished & brushed
- **Hull portlights:** (2) fixed, non-opening
- **Lights, recessed:** (9 total) LED
 - (6) overhead
 - (3) over berth head
- **Lights, accent:** recessed under berth
- **Lights, directable:** (2) imported with contemporary design directable for reading
- **Overhead hatch:** translucent, lockable, with self-storing fold-down stainless steel egress ladder
- Rocker light switches
- **Sheet set embroidered with Marquis™ logo:** fitted sheet, flat sheet, two pillow cases
- **Soffit:** oak wood grille
- Storage cabinets (6)
- **Storage drawer:** extra-large
- **Surround shelves:** open-grained select oak hardwood
- **Wall covering:** silk/cotton blend
- **Wardrobe lockers:** (2) full-height, cedar-lined, carpeted, automatic light, mirrored doors, magnetic door catches
- **Window treatments:** roman shades with recessed headrail

Guest Stateroom

- **Berths:** (2) twin, inner-spring mattress, with upholstered headboards, side boards, & bulkhead bolsters
- **Berth nightstand:** open grained select oak hardwood inlay top and sea rail, drawer beneath
- **Carpet:** patterned cut & loop saxony; 100% polypropylene with advanced stain protection; fade/wear/crush-resistant; 35 oz.; multi-year warranties; with pad
- **Designer décor:** consisting of premium wall coverings & fabrics
- Electrical outlet
- **Entrance door:** solid oak wood, secures open & closed, stainless steel hardware
- **Hanging locker:** full-height, cedar-lined, automatic light
- **Hardware highlights:** stainless steel, polished & brushed
- **Hull portlight:** with screen
- **Light, sconce:** brushed aluminum with shade by Cantalupi® of Viareggio, Italy
- **Lights, overhead, recessed:** (6) LED
- **Lights, accent:** recessed under berths
- Overhead storage
- Private guest head access
- Rocker light switches
- **Sheet sets embroidered with Marquis™ logo:** (2) fitted sheet, flat sheet, pillow case
- **Soffit:** oak wood grille
- **Storage:** beneath berths
- **Wall covering:** silk/cotton blend
- **Window treatment:** roman shade with recessed headrail

MARQUIS

SPECIFICATIONS

690 MARQUIS

Head

- Electrical outlet
- **Entrance doors:** (2) [VIP stateroom, bi-fold, solid cherry wood] Foyer & third stateroom, 3-panel, solid cherry wood frame with sapele pommelle wood panels exterior, cherry wood panels interior, secure open & closed, stainless steel hardware]
- Exhaust fan
- **Flooring:** granite
- Hardware highlights: stainless steel, polished & brushed
- **Light, overhead, recessed:** (4) LED
- **Medicine cabinets:** (2) mirrored doors
- Mirrored ceiling
- Rocker light switches
- Soap dispenser
- **Toilet:** VacuFlush® , pedestal
- Towel bar & ring
- **Towel set:** bath towel, hand towel, washcloth
- **Vanity:** cherry wood, high gloss jewel finish, with granite top & backsplash, stainless steel sink, cabinet beneath

SHOWER STALL

- **Hull portlight:** frosted privacy glass, with screen
- **Light, overhead, recessed:** LED
- Nonskid sole
- **Shelf:** granite, integral to hull
- **Shower door:** clear acrylic in gasketed, aluminum frame
- **Shower head:** detachable for use as hand shower
- Towel bar

Master Head

- **Cabinet:** high gloss jewel finish with sea rail
- **Designer décor:** consisting of premium wall coverings & fabrics
- Electrical outlets
- **Entrance door:** solid cherry wood, herringbone pattern, mirror on stateroom side, secures open & closed, stainless steel hardware
- Exhaust fan
- **Flooring:** marble
- **Hardware highlights:** stainless steel, polished & brushed
- **Hull portlight:** frosted privacy glass with screen
- **Lights, overhead, recessed:** (2) LED
- **Lights, recessed:** (7) over & next to vanity mirror
- **Medicine cabinet:** 4 shelves with sea rails
- **Mirror:** on bulkhead & ceiling over vanity
- Rocker light switches
- **Soffit:** high gloss jewel finish, cherry wood grille
- **Toilet:** Tecma® Silence, full-size, electric pump flush
- Toilet paper holder: wall-mounted
- Towel bars (2)
- **Towel sets:** (2) bath towel, hand towel, washcloth
- **Vanity:** marble countertop & backsplash, stainless steel grab rail across front, his & hers under-mounted solid surface molded sinks, 2 cabinets beneath with sea rails
- **Wall covering:** silk/ cotton blend

SHOWER COMPARTMENT

- **Light, overhead, recessed:** LED
- **Shelves:** (3) fiberglass, with stainless steel sea rails
- **Shower door:** clear glass in gasketed polished aluminum frame
- **Shower head:** detachable for use as handshower
- Soap dish
- Towel bar
- **Walk-in shower:** tiled

MARQUIS

SPECIFICATIONS

690 MARQUIS

Guest Head

- **Cabinet:** high gloss jewel finish, 3 shelves with sea rail
- Electrical outlet
- **Entrance doors:** (2) dual access (guest stateroom & foyer), solid cherry wood, herringbone pattern, secure open & closed, stainless steel hardware
- Exhaust fan
- **Flooring:** marble
- **Hardware highlights:** stainless steel, polished & brushed
- **Lights, overhead, recessed:** (2) LED
- **Lights, over vanity, recessed:** (2) LED
- **Medicine cabinet:** mirrored door, 2 shelves with sea rail
- **Mirrored bulkhead:** over vanity
- Rocker light switch
- **Soffit:** high gloss jewel finish, cherry wood grille, over vanity
- **Toilet:** Tecma® Silence, full-size, electric pump flush
- **Toilet paper holder:** wall-mounted
- Towel bar & ring
- **Towel set:** bath towel, hand towel, washcloth
- **Vanity:** marble countertop & backsplash, stainless steel grab rail across front, undermounted solid surface molded sink, cabinet beneath with sea rail
- **Wall covering:** silk/cotton blend

SHOWER STALL

- **Bench seat:** integral
- **Hull portlight:** frosted privacy glass with screen
- **Light, overhead, recessed:** LED
- Nonskid sole
- Soap dish
- **Shower door:** clear glass in gasketed polished aluminum frame
- **Shower head:** detachable for use as handshower

VIP Head

- **Cabinet:** recessed, 5 shelves with sea rails
- Electrical outlet
- **Entrance door:** solid cherry wood, herringbone pattern, secures open & closed, stainless steel hardware
- Exhaust fan
- **Flooring:** marble
- **Hardware highlights:** stainless steel, polished & brushed
- **Lights, overhead recessed:** (2) LED
- **Lights, over vanity, recessed:** (2) LED
- **Medicine cabinet:** mirrored door, 2 shelves with sea rail
- **Mirrored bulkhead:** over vanity
- Rocker light switches
- **Soffit:** high gloss jewel finish, cherry wood grille, over vanity
- **Toilet:** Tecma® Silence, full-size, electric pump flush
- **Toilet paper holder:** wall-mounted
- Towel bars (2)
- Towel ring
- **Towel set:** bath towel, hand towel, washcloth
- **Vanity:** marble countertop & backsplash, stainless steel grab rail across front, undermounted solid surface molded sink, cabinet beneath with sea rail
- **Wall covering:** silk/cotton blend

SHOWER STALL

- **Bench seat:** integral
- **Hull portlight:** frosted privacy glass with screen
- **Light, overhead, recessed:** LED
- Nonskid sole
- **Shower door:** clear glass in gasketed polished aluminum frame
- **Shower head:** detachable for use as handshower
- Towel bar

MARQUIS

SPECIFICATIONS

690 MARQUIS

Dual Master Head (Option)

- **Designer décor:** consisting of premium wall coverings & fabrics
- **Flooring:** marble
- **Hardware highlights:** stainless steel, polished & brushed
- Rocker light switches
- **Towel sets:** (2) bath towel, hand towel, washcloth

HIS COMPARTMENT

- **Cabinet:** with sea rail
- Electrical outlet
- **Entrance door:** solid cherry wood, herringbone pattern, mirror on stateroom side, secures open & closed, stainless steel hardware
- Exhaust fan
- **Hull portlight:** frosted privacy glass with screen
- **Lights, recessed:**
 - (2) overhead, LED
 - (5) over & next to vanity mirror
- **Medicine cabinet:** 4 shelves with sea rails
- **Mirror:** on bulkhead & ceiling over vanity
- **Soffit:** high gloss jewel finish, cherry wood grille
- **Toilet:** Tecma® Silence, full-size, electric pump flush
- **Toilet paper holder:** wall-mounted
- Towel bars (2)
- **Vanity:** marble countertop & backsplash, stainless steel grab rail across front, undermounted solid surface molded sink, cabinet beneath with sea rail
- **Wall covering:** silk/cotton blend

HERS COMPARTMENT

- **Cabinet:** with sea rail
- Electrical outlets
- **Entrance door:** solid cherry wood, herringbone pattern, mirror on stateroom side, secures open & closed, stainless steel hardware

Dual Master Head (Option) (Cont'd)

- Exhaust fan
- **Hull portlight:** frosted privacy glass with screen
- **Lights, Recessed:** (9 Total) LED
 - (2) overhead
 - (2) over vanity
 - (5) over & next to make-up vanity mirror
- **Make-up vanity:** marble countertop, grab rail across front, drawer beneath, wooden stool
- **Medicine cabinet:** 4 shelves with sea rails
- **Mirror:** on bulkhead & ceiling over vanity
- **Soffit:** cherry wood grille
- **Toilet:** Tecma® Silence, full-size, electric pump flush
- **Toilet paper holder:** wall-mounted
- Towel bars (2)
- **Vanity:** marble countertop & backsplash, stainless steel grab rail across front, undermounted solid surface molded sink, cabinet beneath with sea rail
- **Wall covering:** silk/cotton blend

WALK-IN TILE SHOWER

- **Entrance doors:** (2) dual access (his & hers compartments) clear glass in gasketed polished aluminum frame
- **Light, overhead, recessed**
- **Shower head:** detachable for use as handshower
- Walk-in tile shower

MARQUIS

SPECIFICATIONS

690 MARQUIS

Pilothouse (Option)

- **Access doors:** (2) provide access to wiring below helm
- **Accessory space:** for installing navigation electronics in helm
- **Adapter:** 12V, at helm
- **Cabinets:** open-grained select oak hardwood, marble sole accent
- **Carpet:** patterned cut & loop saxony; 100% nylon with advanced stain protection; fade/wear/crush-resistant; 35 oz.; multi-year warranties; with pad
- **Circuit breakers:** for helm controls
- Electrical outlets
- **Helm:** fiberglass with faux walnut burl & leather accents
- **Helm seat:** ultraleather upholstery, 6-way electrically adjustable
- **Lights, overhead recessed:** (6 total)
 - (1) overhead, recessed, red illumination for night operations
 - (5) overhead, recessed
- **Lounge:** curved, ultraleather upholstery, accommodates 4 adults
- **Steering wheel:** wood rim & hub, adjustable
- Rocker light switch
- Windshield defoggers (3)
- **Windshield wipers:** (3) pulse, each with fresh water washer

Crew Quarters (Option)

- **Access door:** to starboard mechanical compartment
- **Air conditioning:** 6,000 BTU
- **Berth:** twin-sized, foam
- **Cabinet:** with TV connection inside
- Electrical outlet
- **Entrance doors:** (2) dual access (engine room & boarding platform); watertight; engine room door has porthole, keyed deadbolt, triple latch
- **Light, scone:** directable for reading
- **Lights, overhead, recessed:** (3) LED
- **Light switch:** for engine room/mechanical compartments
- Rocker light switches

Crew Quarters Head (Option)

- **Access door:** to port mechanical compartment
- Clothes hook
- Electrical outlet
- **Entrance door:** plexiglass in aluminum frame, secures closed, matching sidelight
- Exhaust fan
- **Handshower:** retractable sink spigot
- Hanging locker
- **Light, recessed:** (2 total)
 - (1) overhead, recessed
 - (1) over vanity, recessed
- **Mirrored bulkhead:** over vanity
- Rocker light switch
- **Vanity:** fiberglass, stainless steel sink, cabinet beneath

MARQUIS

OWNER PREFERENCES

PROPULSION:

- CAT® C18*: 1015 hp
- MTU® 8V2000: 1250 hp
- MTU® 10V2000: 1360 hp
- CAT® C32: Acert1470 hp
- MTU® 10V2000: 1600 hp
- CAT® C32: Acert 1723 hp

MECHANICAL:

- Cockpit control station: engine controls & dual joystick control for Marquis Docking System

ELECTRICAL:

- Dual forward shorepower connector
- Forward cablemaster

GENERATOR

- Kohler® 23 kW 60 Hz [20 kW 50 Hz]*: with premium electrical system: cablemaster, remote power source control
- Kohler® 28 kW 60 Hz [23 kW 50 Hz]: with premium electrical system: cablemaster, remote power source control
- Auxiliary Second generator: Kohler® 28 kW 60 Hz [23 kW 50 Hz] (not available with auxiliary fuel tank)

WATER & HOLDING SYSTEMS:

- Grey water holding system (not available with dishwasher or washer & dryer)
- Overboard discharge system

TRANSOM & BOW

WASHDOWNS

- Fresh water only*
- Seawater only
- Both fresh & seawater

SAFETY & NAVIGATION:

- Autopilot: Raymarine® ST70
- Auxiliary fuel tank (not available with optional second generator)
- Dinghy storage cradle (not available with aft bridge extension sunpad)
- Lower helm with controls, gauges & windshield wipers
- SeaKey®: satellite based boat

security, safety & concierge system;
90 day trial subscription (U.S. & Canada only)

DAVIT (not available with aft bridge sunpad option)

- 600 lb. [272 kg] capacity
- 1000 lb. [454 kg] capacity

DUAL COCKPIT CAPSTAN

WINCHES

- VC 500: 24v
- VC 1500: 24v

NAVIGATION ELECTRONICS

PACKAGE

- Bridge Package: Raymarine® E-Series E120 wide multifunction navigation display, Raymarine® 240 VHF (hand set), 125 WAAS GPS sensor, Raymarine® DSM 300 digital sonar module, Raymarine® thru-hull transducer B60 dual frequency 50/200 khz depth/temp thru-hull transducer
- Bridge Package Plus Radar: Includes above bridge package plus Raymarine® E-Series E120 wide multifunction navigation display and 4KW super HD scanner open array
- Bridge & Lower Helm Package: Includes above bridge package plus Raymarine® E-Series E120 wide multifunction navigation display and Raymarine® 240 VHF (hand set)
- Bridge & Lower Helm Package Plus Radar: Includes above bridge & lower helm package plus Raymarine® E-Series E120 multifunction navigation display and 4KW super HD scanner open array

VIDEO MONITOR SYSTEM

- Bridge: Voyager®, 1 monitor & 2 cameras
- Pilothouse: Voyager®, 1 monitor & 2 cameras
- Bridge & pilothouse: Voyager®, 2 monitors & 2 cameras

AMENITIES:

BRIDGE HARDTOP

- Bridge hardtop

- Low profile hardtop

BRIDGE HARDTOP ENCLOSURE

- Soft side enclosure
- Hard side enclosure

BRIDGE TABLE

- Fiberglass*

BRIDGE WET BAR

- Storage*
- Ice maker: Raritan®, produces up to 22 lbs. [10 kg] of ice per day
- Refrigerator: Nova Kool®, 3.6 ft² [102 liters]

BRIDGE WET BAR GRILL

- Single Kenyon® electric stainless steel BBQ grill
- Double Kenyon® electric stainless steel BBQ grills

CANVAS

- Bimini top
- Bimini top with hard side enclosure

WINDLASS

- Maxwell® 4000VMC: low profile package*
- Maxwell® 4000VMC: low profile package with capstan

EXTERIOR

- Aft bridge extension sunpad, with stainless steel rail (not available with davit or dinghy storage cradle)
- Bridge air cooling system [24,000 BTU]
- Bridge lounge slip covers & pillows
- Bridge stereo: waterproof D5 Clarion® AM/FM/CD player, Clarion® 6-disc CD changer, Sirius® satellite radio receiver & Apple iPod® dock
- Exterior carpet package: berber
- Cockpit to bridge stairway hatch
- Cockpit table: wood with protective cover
- Helm & seat covers
- Painted hull: Navy Blue
- Passarelle
- Teak decking on swim platform, cockpit,

690 MARQUIS

& cockpit to bridge steps; inlaid, solid 3/8" [9,5 mm] plank

- Underwater lighting: transom, Ocean LED®, super blue, 40,000 plus hours of life
- Vertical bow rail stanchions (in lieu of outboard flared stanchions)

GALLEY

- Marquis™ Exclusive China, monogrammed, service for 6
- Marquis™ Exclusive Crystal, monogrammed, service for 6 (mineral water glasses, wine glasses & champagne flutes)
- Marquis™ Exclusive Flatware, monogrammed, service for 6
- Dishwasher: Miele® Slimline, stainless steel, built-in, holds 9 place settings, Energy Star® appliance
- Trash compactor: GE®, stainless steel [110 V only]

GALLEY STOVE

- 3 burner top*
- Full size oven/range

PILOTHOUSE

- Helm chair upgrade

PILOTHOUSE DOOR (MUST SELECT ONE)

- Manual*
- Electric
- No door

SALON

- Central vacuum system: Beam®
- Coffee table: high gloss wood

SALON SOFA

- Storage*
- Stowaway bed

STATEROOMS

MASTER STATEROOM

- 32" [81 cm] Sole® LCD TV (built to durable marine grade standards) & Clarion® DVD/CD/MP3 player, enclosed in cabinet
- His & hers master head compartments
- Safe

*Standard Preference

MARQUIS

OWNER PREFERENCES

690 MARQUIS

MASTER STATEROOM (CONT'D)

- Washer & dryer: front loading & energy efficient; in forward walk-in closet

MASTER STATEROOM STEREO

- Stereo: Clarion® AM/FM/CD marine stereo & Apple iPod® dock
- Stereo with surround sound: Bose Lifestyle® 38 Home Entertaining System
- Stereo with surround sound: Bose Lifestyle® 38 Home Entertaining System

VIP STATEROOM

- 20" (50 cm) Sole® LCD TV (built to durable marine grade standards) & Clarion® DVD/CD/MP3 player
- Stereo: Clarion® AM/FM/CD & Apple iPod® dock

THIRD STATEROOM

- 15" Sole® (38 cm) LCD TV (built to durable marine grade standards) & Clarion® DVD/CD/MP3 player
- Overhead storage
- Stereo: Clarion® AM/FM/CD marine stereo & Apple iPod® dock

STERN CABIN

- Lazarette storage with transom door*
- Crew quarters with accommodations for one person; twin-sized foam berth, sink with hand shower, head toilet, and storage

DÉCOR:

ENSEMBLE

- Golden Shores* (brown tones with flecks of gold)
- Biscotti (dark chocolate browns & ivory)

INTERIOR WOOD SPECIES

- Jewel gloss Cherry Wood*
- Jewel gloss Nutmeg Wood

ULTRALEATHER

- Brisa Buckskin*
- Brisa Walnut
- Brisa Cream

OPTIONAL:

VALENTINA ZANIER DESIGNER
CONTEMPORARY INTERIOR DECOR BY
NUVOLARI-LENDARD

An exquisitely fresh interior design creates a contemporary European yacht environment with select oak cabinetry, hand-laid Brazilian cherry salon flooring, handmade Italian leather salon furniture and an enduringly stylish crystal coffee table. The staterooms are furnished with premium linen carpet and scones by Cantalupi® of Viareggio, Italy. The lower heads feature Spanish marble flooring, over-counter basin sink with bold rectangular shape and walk-in tile showers.

FABRIC ENSEMBLE

- Golden Shores* (brown tones with flecks of gold)
- Biscotti (dark chocolate browns and ivory)
- Distinguished premium selection of custom fabrics by Bergamo® and Rubelli® of Italy. Leading designer and importer of the finest upholstery and drapery fabrics

INTERNATIONAL SPECIFICATIONS:

- Electrical systems in 220V
- Entertainment equipment (televisions & stereos) not available in Japan
- Sirius Satellite radio only available in U.S. & Canada
- Some electrical equipment is only offered in 120V/60Hz; check with your Marquis Dealer for availability outside the U.S.

MARQUIS

FLOOR PLANS

690 MARQUIS

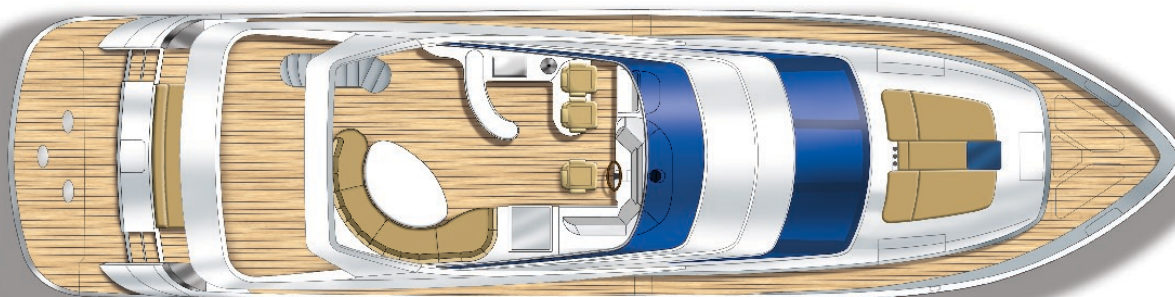

BRIDGE



MAIN DECK

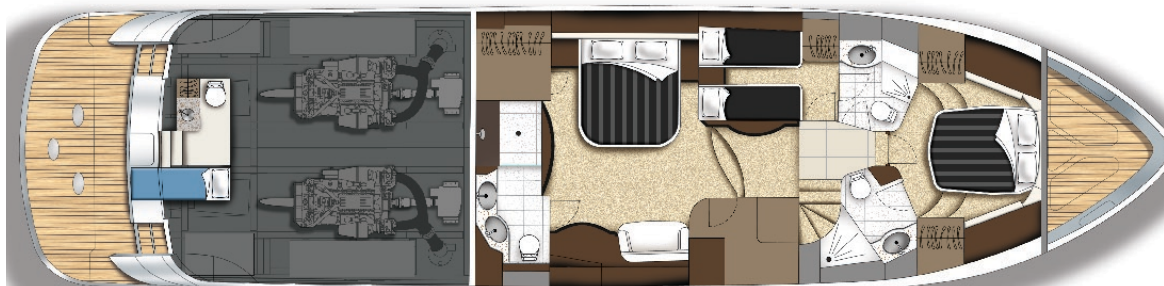

LOWER DECK

Marquis Yachts™ reserves the right to change price, colors, materials, equipment specifications or models without notice. All specifications and measurements are approximate and subject to change. Models may be discontinued without obligation to previous purchasers. Illustrations may include optional equipment. Some electrical equipment is only offered in 120V/60Hz; check with your Marquis Dealer for availability outside the U.S.